

NOTES:
 UTILITIES WILL BE WELL AND SEPTIC SYSTEMS.
 AS OF THE DATE OF THIS RECORDING, THE LOTS REPRESENTED ON THIS PLAT HAVE NOT BEEN INSPECTED OR APPROVED BY THE HEALTH DEPARTMENT. UNTIL INSPECTED, THERE IS NO ASSURANCE THAT A BUILDING PERMIT WILL BE ISSUED.
 FIFTEEN PARCELS WILL BE CREATED FOR SUBDIVISION.
 NO MORE THAN 15 TOTAL LOTS WILL BE CREATED BY ANY FUTURE DEVELOPMENT.
 SMALLEST LOT SIZE CREATED IS 0.69 ACRES (30,058 s.f.) IN LOT 13.
 NO OTHER MONUMENTS FOUND WITHIN 2000'.
 THIS PROPERTY IS NOT LOCATED IN A SPECIAL FLOOD HAZARD AREA AS SHOWN ON F.I.R.M. COMMUNITY MAP NUMBER 370313-0206-C, EFFECTIVE DATE JUNE 22, 1998.
 THE NORTH CAROLINA DEPARTMENT OF TRANSPORTATION WILL REQUIRE P.E. CERTIFICATION OF THE CONSTRUCTION OF ALL STREETS AND ROUTINE DRAINAGE FACILITIES ASSOCIATED WITH THIS SUBDIVISION.
 AS OF MARCH 30, 2003, THE NORTH CAROLINA DEPARTMENT OF TRANSPORTATION WILL REQUIRE ALL SUBDIVISION STREETS TO BE CONSTRUCTED WITH AN APPROVED "SUPERPAVE" MIX DESIGN AND WILL FURTHER REQUIRE QMS CERTIFICATION OF ALL PAVEMENTS.
 BRICK OR MASONRY MAILBOX COLUMNS ARE NOT ALLOWED AND WILL PROHIBIT ADDITION TO THE STATE SYSTEM OF ROAD MAINTENANCE.
 TOTAL SITE AREA = 17.049 ACRES.

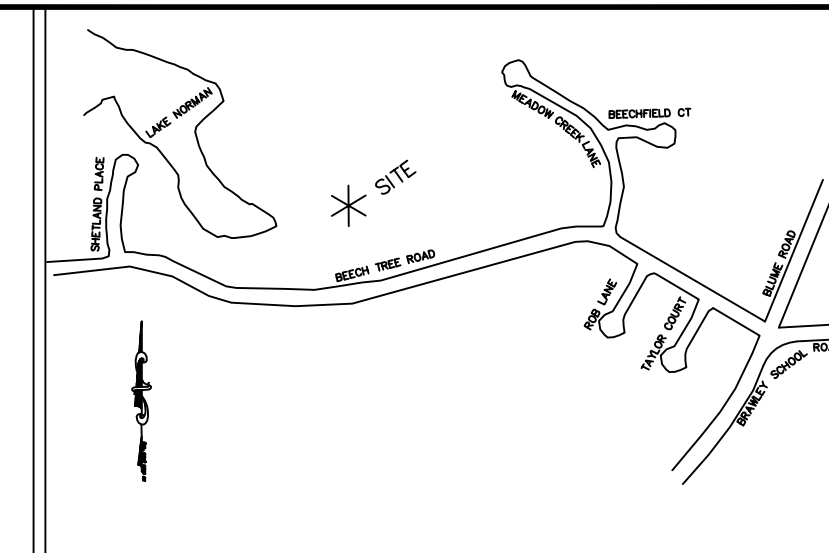

VICINITY MAP
(NOT TO SCALE)

- LEGEND**
- CMF CONCRETE MONUMENT FOUND (CMF)
 - IRF IRON REBAR FOUND (IRF)
 - IPF IRON PIPE FOUND (IPF)
 - IRS IRON REBAR SET (IRS)
 - NPS NO POINT SET (NPS)
 - NTS NOT TO SCALE
 - PROPERTY LINE
 - R/W RIGHT OF WAY
 - C CENTERLINE OF ROAD

ZONING DATA

ZONED: R20 & RA
 TAX PARCEL: SEE PLAN

ZONING ITEM	REQUIRED
MINIMUM R/W SETBACK	35'
MINIMUM SIDE SETBACK	15'
MINIMUM WATERFRONT SETBACK	50'
NON-LAKEFRONT REAR SETBACK	35'

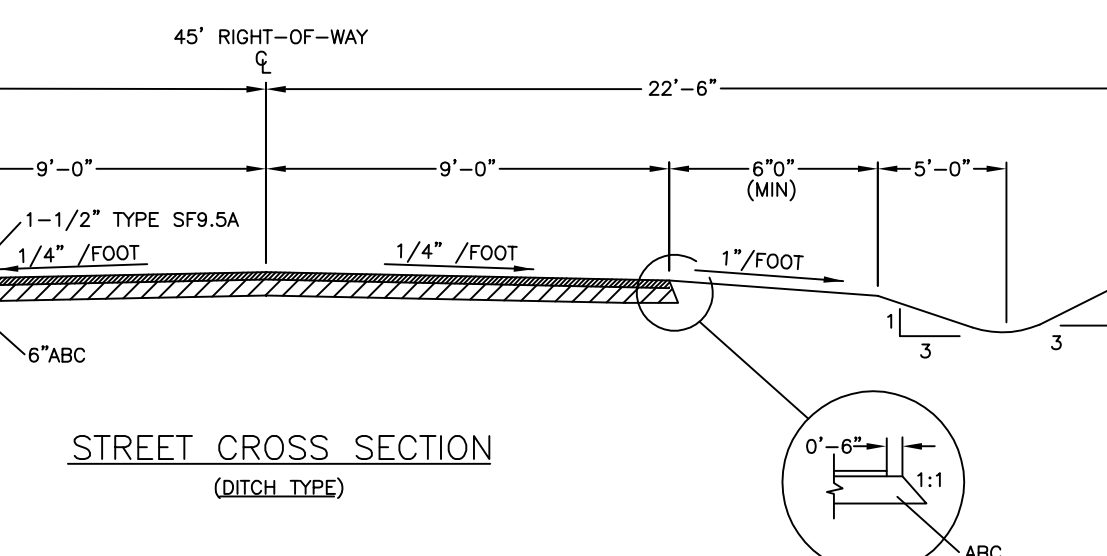
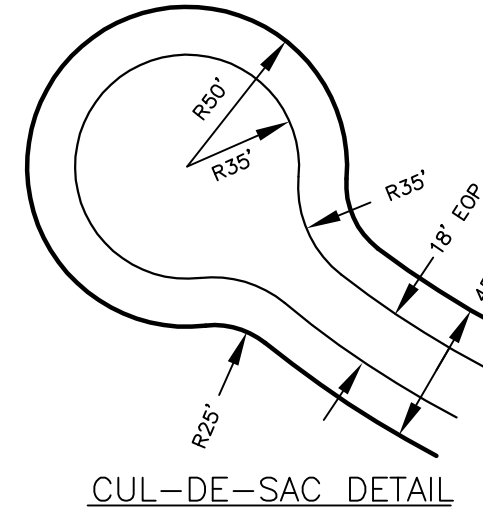

- NOTES**
- ALL DISTANCES ARE HORIZONTAL GROUND DISTANCES UNLESS OTHERWISE NOTED.
 - BOUNDARY SURVEY MADE USING EXISTING PHYSICAL EVIDENCE OBSERVED ON THE DATE OF SURVEY.
 - BEARING BASIS NCGS NAD 83 GRID NORTH.
 - THIS PLAT IS A SURVEY THAT CREATES A SUBDIVISION OF LAND WITHIN THE AREA OF A COUNTY OR MUNICIPALITY THAT HAS AN ORDINANCE THAT REGULATES PARCELS OF LAND.
 - UNLESS SIGNED AND SEALED, THIS PLAT IS PRELIMINARY NOT FOR RECORDATION, SALES OR CONVEYANCE.
 - AREA CALCULATED BY COORDINATE GEOMETRIC METHOD.

FLOOD NOTE

A PORTION OF THIS PROPERTY DOES LIE WITHIN A SPECIAL FLOOD HAZARD AREA DETERMINED BY FLOOD INSURANCE RATE MAP COMMUNITY NUMBER 370313 0200 C (06/22/98) PUBLISHED BY FEDERAL EMERGENCY MANAGEMENT AGENCY.

CURVE TABLE

CURVE	LENGTH	RADIUS	CH. BEARING	CHORD
C1	8.62'	172.50'	N16°55'58"W	8.62'
C2	112.90'	172.50'	N37°06'49"W	110.90'
C3	9.04'	172.50'	N57°21'51"W	9.03'
C4	71.50'	322.50'	N65°13'00"W	71.36'
C5	76.84'	277.50'	S63°38'08"E	76.60'
C6	14.44'	277.50'	S84°12'42"E	14.44'
C7	24.88'	25.00'	S24°12'45"E	23.86'
C8	81.14'	50.00'	N42°11'38"W	72.53'
C9	26.24'	50.00'	S76°16'53"W	25.94'
C10	43.27'	50.00'	S36°27'20"W	41.93'
C11	52.04'	50.00'	S18°09'03"E	49.72'
C12	42.50'	50.00'	S72°18'57"E	41.23'
C13	19.95'	25.00'	N73°47'51"W	19.43'
C14	83.61'	322.50'	S58°21'24"E	83.38'
C15	32.56'	322.50'	S68°40'35"E	32.54'
C16	12.01'	277.50'	N70°19'44"W	12.01'
C17	49.52'	277.50'	N63°58'37"W	49.45'
C18	87.24'	127.50'	N39°15'48"W	85.55'
C19	9.26'	127.50'	N17°34'54"W	9.26'

LINE TABLE

LINE	BEARING	LENGTH
L50	S 71°34'06" E	30.66'
L51	S 71°34'06" E	24.26'
L52	N 71°34'06" W	50.85'
L53	N 58°51'53" W	49.56'
L54	N 58°51'53" W	45.10'
L55	S 60°40'41" E	7.46'

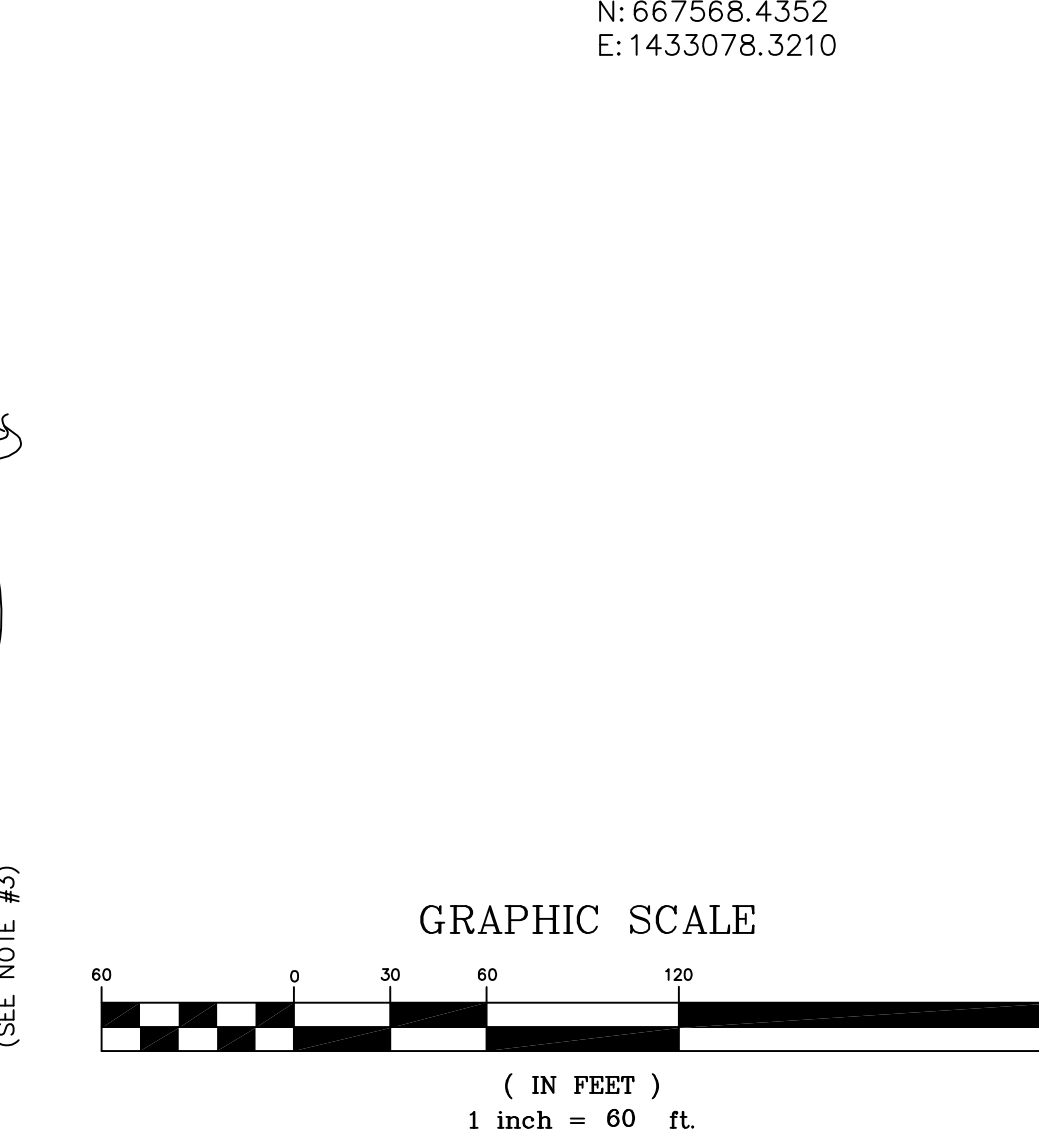

CLIENT

DATE: 7-15-05
 DESCRIPTION: REVISIONS FOR SEPTIC FIELDS

MEADE GUNDELL
 Surveying & Engineering, P.C.
 1880-A West Catawba Avenue
 Cornelius, N.C. 28031
 704-655-7290 704-655-7291 (fax)

DATE
 12/14/04

BEECH TREE BAY SUBDIVISION
 PB 38-33 & 44-64
 DAVIDSON TOWNSHIP, IREDELL COUNTY, NC

SITE PLAN

JOB NUMBER: 755.20
 SHEET NUMBER: C-400